



Redefining Healthcare Food Service

With Alluserv you are not just buying a product. You are receiving our team's service commitment to get the most value from your investment in our products. We will provide you with:

- A team of knowledgeable experts with over 100 years of combined experience to help you understand and receive the most from your product throughout its service life
- Detailed instructions and specification on cleaning and application to best maintain your equipment
- A national service network and service manuals for our extensive product offering.

CHOICE TRAY CART

APPLICATION

The Alluserv tray delivery cart is designed for transportation of patient meals to decentralized locations. The all stainless construction cart features fixed tray sides, 5-1/4" tray spacing that accommodates two each 14"x18", 15"x20" or room service trays per side.

CONSTRUCTION

The Alluserv tray cart has a 1" thick 18-gauge stainless steel tubular frame with welded, 18-gauge, pre-formed side panels/tray slides. Top, bottom and single panel door are 18-gauge stainless steel. Door has recessed door pull with a top mounted heavy-duty drop door latch. The door has a 270° swing.

Casters are 6" in diameter, with 2 fixed and 2 swivel with brakes, and are 2" rounded with soft tread to ensure a smooth and quiet ride for carpet or tile.

Choice Tray Cart

Model Numbers:

**TDC10, TDC12, TDC16, TDC20,
TDC24, TDCPT10, TDCPT12,
TDCPT16, TDCPT20, TDCPT24**



Standard Features

- All stainless steel construction
- 6" casters, 2 with brakes
- 14"x18", 15"x20" trays & room service trays, 2 trays per slide
- Pull-type door with magnets & transport latch
- Small footprint

Options

- Push handle (non pass thru only)
- Corner bumpers
- Wrap around bumpers
- Drains
- Top rails (for 16 capacity size and under)
- Tow hitch Package

Warranty

- Two years parts and one year labor

888.892.2213 | alluserv.com

Choice Tray Cart

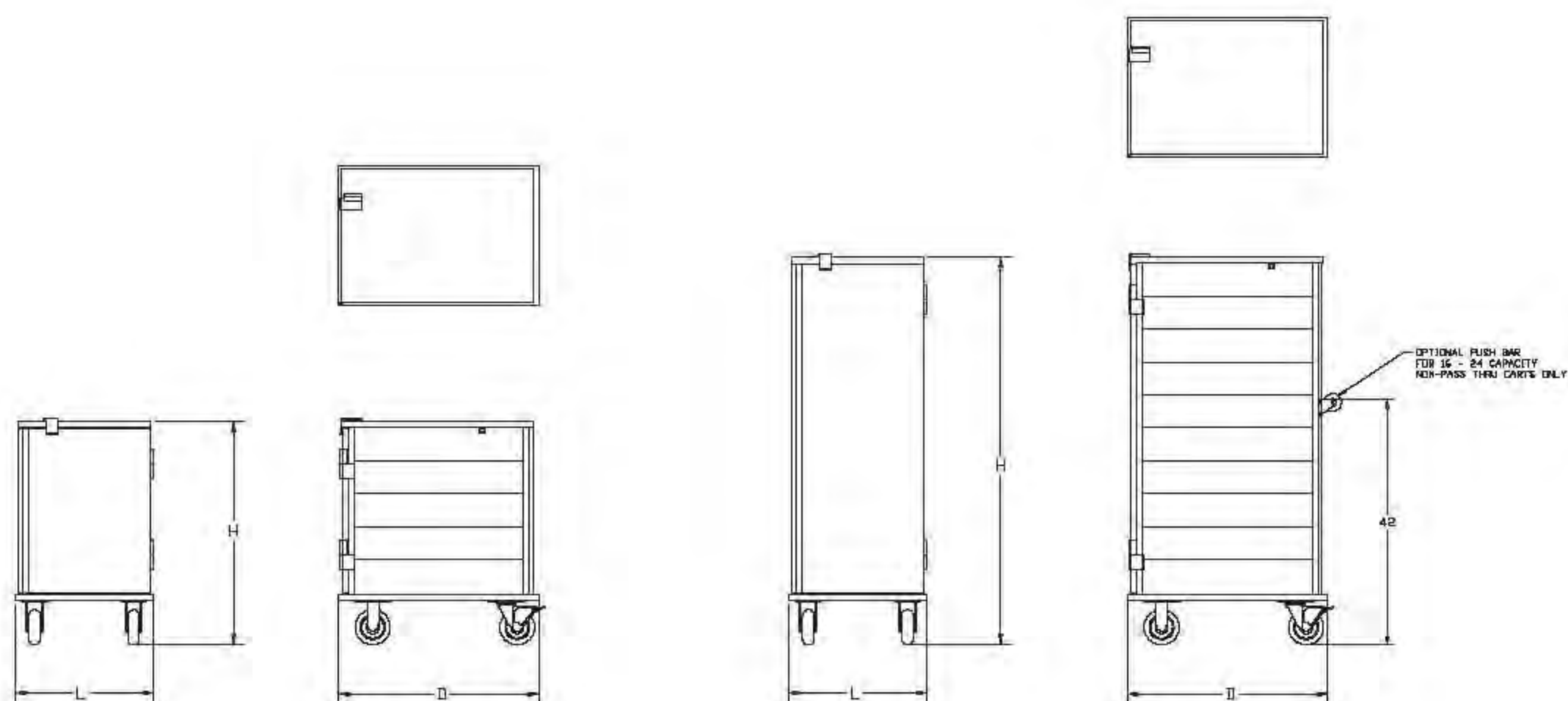

DIMENSIONS

MODEL	CASE WEIGHT	PASS THRU MODEL	CASE WEIGHT	OVERALL SIZE			TRAY CAPACITY
				D	L	H	
TDC10	215	TDCPT10	220	34-7/32"	23-3/4"	37-1/8"	10
TDC12	235	TDCPT12	240	34-7/32"	23-3/4"	42-3/4"	12
TDC16	275	TDCPT16	285	34-1/4"	23-3/4"	54"	16
TDC20	295	TDCPT20	305	34-1/4"	23-3/4"	65-1/4"	20
TDC24	315	TDCPT24	325	34-1/4"	23-3/4"	76-1/2"	24



901 West 14th Street | Suite 200 | Washington, MO | 63090 | toll free 888-892-2213 | fax 636-239-8435 | alluserv.com